

# Minimal Ruota Soft-close V-6150

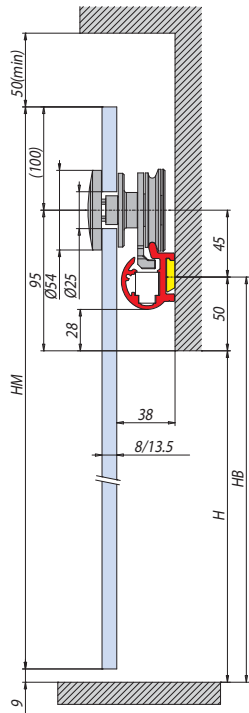

Sistema scorrevole con ruote a vista su binario tondo e Soft-close  
 Sliding system with visible point rollers and round rail with Soft-close  
 Schiebetürsystem mit punkttroller, runde Laufschiene und Soft-close



$$HM = H + 186$$

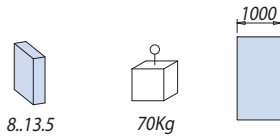
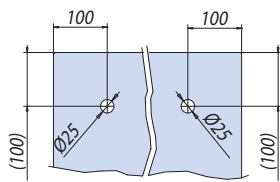

## V-6150 set 1 Soft-close

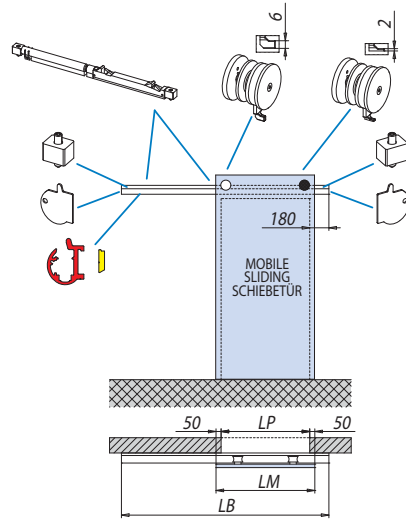

$$LB = LP \times 2 + (50 \times 2) + 300$$

$$LM = LP + 100$$

## V-6150 set 2 Soft-close

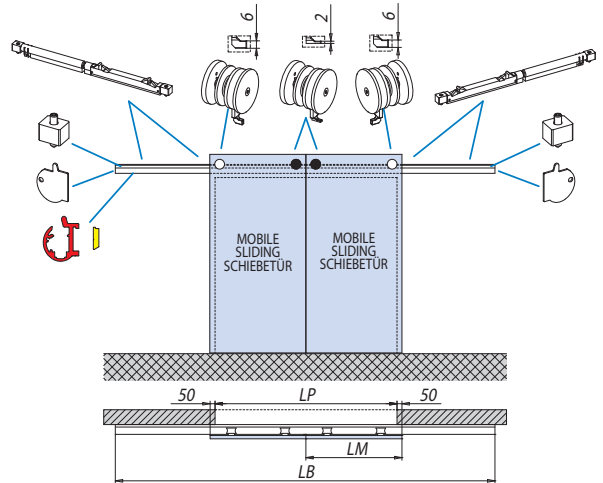

$$LB = LP \times 2 + (50 \times 2) + 250$$

$$LM = (LP + 100) / 2$$

Componenti  
 Components  
 Einzelteile

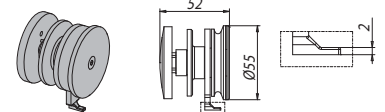
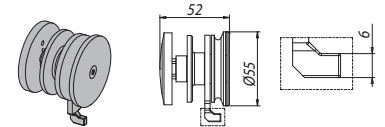
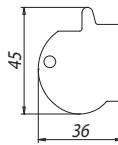
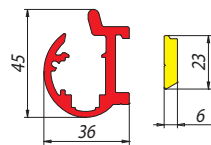

Soft-close

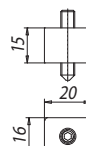
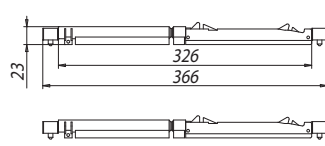

CR = Cromo lucido  
 Polished chrome  
 Chrom glänzend

Effetto inox  
 Inox effect  
 Inox effekt

H = Altezza passaggio luce - Clear opening height - Lichte Höhe  
 LP = Passaggio luce - Clear opening width - Lichte Breite  
 HM = Altezza anta mobile - Sliding glass height - Schiebefügel Höhe  
 LM = Larghezza vetro - Glass width - Glasbreite  
 LB = Lunghezza binario - Rail length - Laufschiene Länge

xla346b

# Minimal Ruota Soft-close V-6150



Montaggio a vetro  
Glass installation  
Glasmontage



Montaggio a vetro  
Glass installation  
Glasmontage

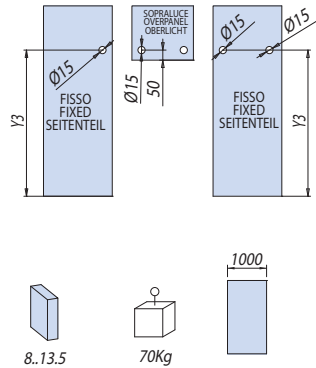
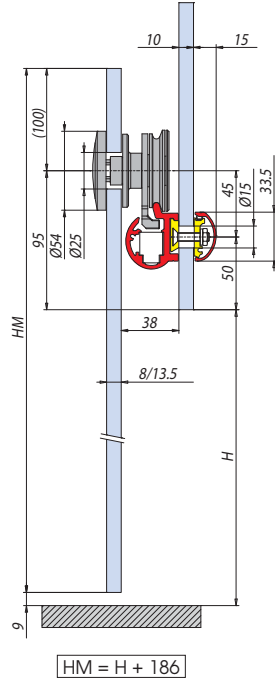

V-6150 set 3 Soft-close

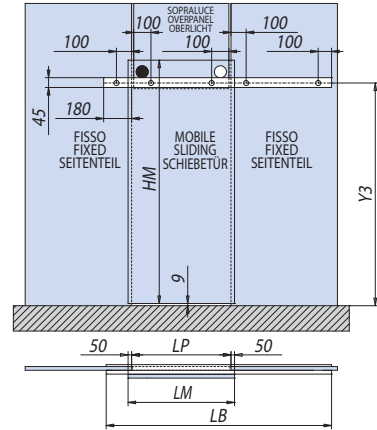

$$LM = LP + 100$$

$$LB = LP \times 2 + (50 \times 2) + 300$$

$$Y3 = H + 50$$

V-6150 set 4 Soft-close

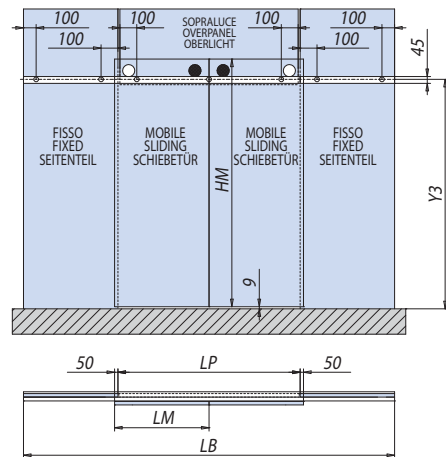

$$LM = (LP + 100) / 2$$

$$LB = LP \times 2 + (50 \times 2) + 250$$

$$Y3 = H + 50$$

Y3: Altezza fori vetri fissi e nel sopraluce  
Height glass holes in side-and overpanel  
Höhe glasbohrungen in seitenteil-oberlicht

V-6006

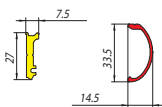

V-6007

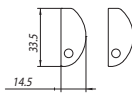

Fori da parte del cliente  
Profile not predrilled  
Profil nicht vorgebohrt

Altri componenti a pag. 20  
Other components at page 20  
Andere Einzelteile Seite 20

Regolazione  
verticale  
Adjustment  
Verstellung

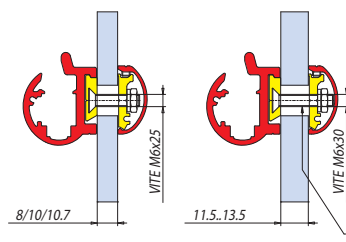
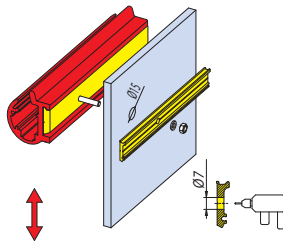

Accorciare vite sul cantiere  
Short screw during installation  
Schrauben baauseits kürzen

CR = Cromo lucido  
Polished chrome  
Chrom glänzend

Effetto inox  
Inox effect  
Inox effekt

H = Altezza passaggio luce - Clear opening height - Lichte Höhe  
LP = Passaggio luce - Clear opening width - Lichte Breite  
HM = Altezza anta mobile - Sliding glass height - Schiebefügel Höhe  
LM = Larghezza vetro - Glass width - Glasbreite  
LB = Lunghezza binario - Rail length - Laufschiene Länge

xia346c



